

This drawing is protected under Copyright and all no fee must any portion of this drawing be reproduced or copied in anyway without the permission of Morgan Lovell.
All dimensions must be checked on site and NOT scaled from this drawing.

SUBJECT TO SITE SURVEY
CHECK SURVEY UNDERTAKEN ONLY
BUILDING PARAMETERS TAKEN FROM DRAWINGS PROVIDED
BUILDING PARAMETERS TAKEN FROM AS BUILT DRAWINGS PROVIDED

CHINESE WALL (ACCESS CONTROL)
FURNITURE HATCHED IS SHOWN AS EXISTING AND REUSED WHERE APPROPRIATE SPATIALLY - UNDER REVIEW WITH CLIENT
OFFICE FURNITURE FOR FIXED INCOME IS BASED ON 1830 X 1830 (EXISTING) WORKSTATIONS
OFFICE FURNITURE FOR REAL ESTATE IS BASED ON 1800 X 800 (NEW) WORKSTATIONS
OFFICE FURNITURE FOR PMCC & SHARED SERVICES IS BASED ON 1600 X 800 (NEW WORKSTATIONS)
ALL STORAGE REQUIREMENTS ARE UNDER REVIEW WITH INDIVIDUAL DEPARTMENTS
REUSE TASK CHAIRS, REVIEW CONDITION AND SUPPLEMENT WHERE NECESSARY
STORAGE LIN. MTRS IS TAKEN FROM PUBLIC SPACE ON FLOOR STORAGE, NOT PERSONAL STORAGE (I.E. PEDESTALS / OFFICES / COAT STORAGE)

- 3 HIGH DRAWER STORAGE UNITS - TBC
1 LINEAR METER LONG
- 5 HIGH SHELVING STORAGE UNITS
1 LINEAR METER LONG

| TOILETS / SHOWERS | CURRENT LAYOUT |
|---|---------------------------|
| 4 Unisex Superloos | 9 Unisex Superloos |
| 1 Disabled WC | 1 Dis. WC / Shower |
| 3 Female WCs | |
| 2 Male WCs | |
| 3 Male Urinals | |
| 2 Unisex Superloo (in showers) | |
| 3 Unisex Showers | |
| Total: 12 WCs 3 urinals 3 showers | Total: 10 WCs 1 shower |

NORTHUMBERLAND AVENUE

REAL ESTATE

CORE 5

CORE 6

CORE 4

CORE 2

CORE 3

CORE 7

SHARED SERVICES

UCITS

FIXED INCOME

PMCC

MEETINGS

STRAND

FIXED INCOME

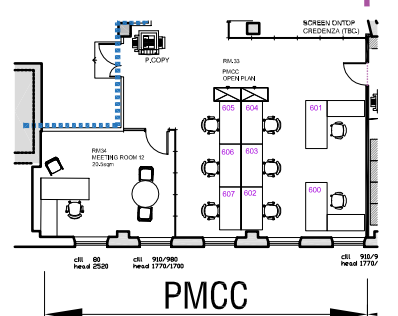
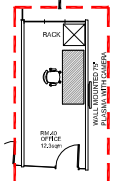
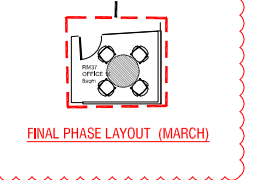
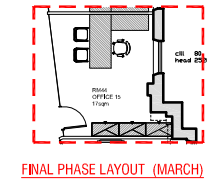
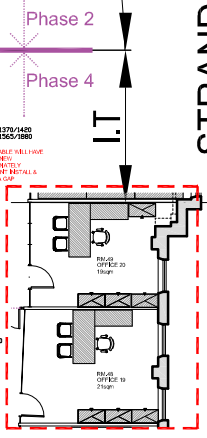

6TH FLOOR
SCALE 1:100

Phase 1 - MEZZANINE REAL ESTATE
Phase 2 - 6th REAL ESTATE
Phase 3 - MEZZANINE FIXED INCOME
Phase 4 - 6th FIXED INCOME
Phase 5 - MEZZANINE FINAL PLAN
Phase 6 - 6th PMCC FINAL PLAN

| REV | DESCRIPTION | DATE | BY |
|-----|--|--------------|----|
| 1 | SHOW MR. LAMMERS TO MEZZANINE ROOM PHASE 4 | AGL 14.12.15 | |
| 2 | UPDATE FIXED INCOME LAYOUT | AGL 08.12.15 | |
| 3 | UPDATE ET OPEN PLAN | AGL 07.12.15 | |
| 4 | VIRIDUS REVISIONS AS CLOUSED | VM 01.12.15 | |
| 5 | UPDATES TO ROOMS 81 & 82 | VM 23.11.15 | |
| 6 | SHIRING SPACES ADDED, ROOMS 7 & 8 FURNITURE CHANGED | VM 24.11.15 | |
| 7 | IT DEPT DEPARTMENT ADDED FILING & CHANGING DESK | VM 16.11.15 | |
| 8 | PHOTO & BANG NEW GLASS ADDED, FILMS ADDED AS CLOUSED | VM 14.11.15 | |
| 9 | VIRIDUS CHANGES AS CLOUSED | VM 11.10.15 | |
| 10 | OFFICE BLOCK PART 2, SHARED SERVICES DEPARTMENTS | VM 26.08.15 | |
| 11 | STORAGE ADDED ROOMS 54, 55, 56, 57, DESK ADDED CORE 7 | VM 21.08.15 | |
| 12 | TABLET 801 & 801 B CORE 6 REBUILT | VM 20.08.15 | |
| 13 | ROOM 81 REBUILT TO 3 DESKS, NOTE ADDED ROOM 25 | VM 14.08.15 | |
| 14 | PHOTO BLOCK PART 2, SHARED SERVICES DEPARTMENTS CHANGED TO 3.5m DESKS, FIXED INCOME AREA RM41 CHANGED TO OFFICE, SHIRING GLASS ADDED TO WALL | VM 12.07.15 | |
| 15 | VIRIDUS REVISIONS AS CLOUSED | VM 20.07.15 | |
| 16 | UPDATED AS CLOUSED, ANY NOTED ADDED | VM 12.07.15 | |
| 17 | OFFICE BLOCK PART 2, SHARED SERVICES ADDED AT OFFICE 14-2 | VM 01.07.15 | |
| 18 | ROOM 25: 24, 27 DOORS REMOVED | VM 28.06.15 | |
| 19 | REVISIONS AS CLOUSED | VM 01.06.15 | |
| 20 | REVISIONS AS CLOUSED | VM 01.06.15 | |
| 21 | REVISIONS AS CLOUSED | VM 01.06.15 | |
| 22 | CONTRACT DRAWING NO. GA 13.06 (2015) | VM 06.05.15 | |

CONSTRUCTION

Morgan Lovell

18 N Hill Street, London, W1P 8QA
T: 0207 734 4466 F: 0207 734 2989 E: contact@morganlovell.com
W: http://www.morganlovell.com

Client
PRAMERICA
Project
THE GRAND BUILDINGS
1-3 STRAND
LONDON
WC2N 5HR

6TH FLOOR
GENERAL ARRANGEMENT PLAN

| Scale | Date | Design/Drawn By | Checked By |
|----------|------------|-----------------|------------|
| 1:100@A0 | 13/01/2016 | RJ / VM | VM |

| Drawing Number | Project No. | Floor | Drawing No. | Rev |
|----------------|-------------|-------|-------------|-----|
| ML1981 | 6 | 100 | X | |

